

COPYRIGHT
 Copyright of the information shown herein remains the property of Lynton Surveys Pty Ltd. Written authority is required for any reproduction. This drawing is confidential and shall be used for the purposes of this project only. Do not scale, written dimensions to be used only. Refer any discrepancies to the surveyor.

APPROXIMATE NORTH

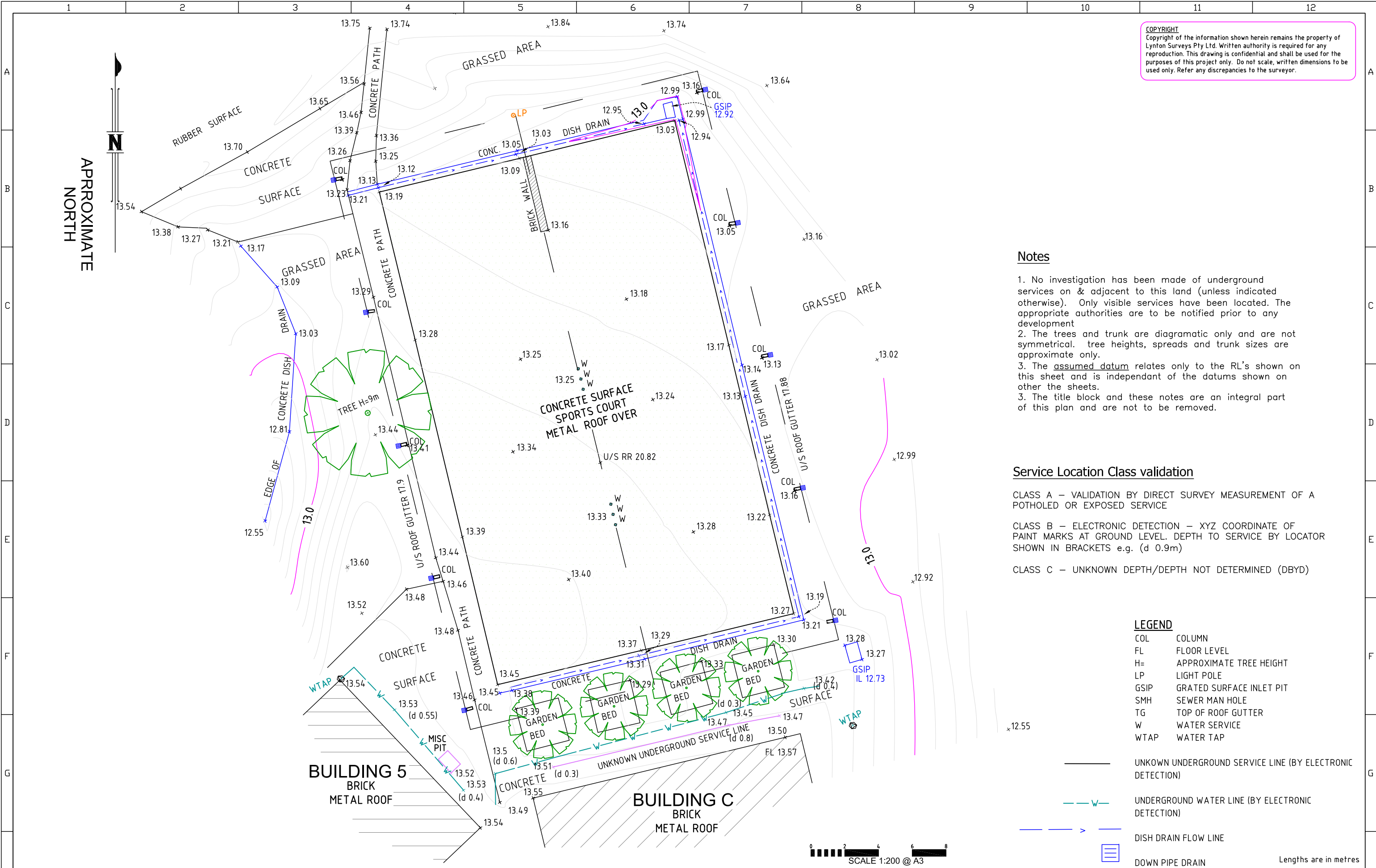

Notes

1. No investigation has been made of underground services on & adjacent to this land (unless indicated otherwise). Only visible services have been located. The appropriate authorities are to be notified prior to any development
2. The trees and trunk are diagrammatic only and are not symmetrical. tree heights, spreads and trunk sizes are approximate only.
3. The assumed datum relates only to the RL's shown on this sheet and is independant of the datums shown on other the sheets.
3. The title block and these notes are an integral part of this plan and are not to be removed.

Service Location Class validation

- CLASS A – VALIDATION BY DIRECT SURVEY MEASUREMENT OF A POTHOLED OR EXPOSED SERVICE
- CLASS B – ELECTRONIC DETECTION – XYZ COORDINATE OF PAINT MARKS AT GROUND LEVEL. DEPTH TO SERVICE BY LOCATOR SHOWN IN BRACKETS e.g. (d 0.9m)
- CLASS C – UNKNOWN DEPTH/DEPTH NOT DETERMINED (DBYD)

LEGEND

- COL COLUMN
- FL FLOOR LEVEL
- H= APPROXIMATE TREE HEIGHT
- LP LIGHT POLE
- GSIP GRATED SURFACE INLET PIT
- SMH SEWER MAN HOLE
- TG TOP OF ROOF GUTTER
- W WATER SERVICE
- WTAP WATER TAP

- UNKNWN UNDERGROUND SERVICE LINE (BY ELECTRONIC DETECTION)
 - W — UNDERGROUND WATER LINE (BY ELECTRONIC DETECTION)
 - - - > - - - DISH DRAIN FLOW LINE
 - ▮ DOWN PIPE DRAIN
- Lengths are in metres

| | | | | | | | | | | | |
|---|--------|---------------------------------------|----------|--------------|----------------|--|-------------------------------|--|--------------------------|--------------|----|
| <p>Lynton Surveys Pty Ltd LAND & ENGINEERING SURVEYS</p> <p>SYDNEY BRISBANE ADELAIDE ABN 27 084 774 514 T (02) 8338 8788 F (02) 8338 8600 www.lyntonsurveys.com.au HEAD OFFICE: 14/56 O'Riordan Street, Alexandria NSW 2015</p> | REV. A | DETAILS OF AMENDMENT ISSUED TO CLIENT | APP'D MC | DATE 24/5/14 | SURVEYED MC/PB | SURVEY DATE 14/5/2014 | CLIENT DEPARTMENT OF COMMERCE | PLAN SHOWING DETAIL & LEVELS OVER PART OF WILLIAM DEAN PUBLIC SCHOOL, DEAN PARK, SPORT COURT | DRAWING No. 2014C215_DET | | |
| | | | | | DRAWN MC | DATUM ASSUMED | | | REV. SHEET No. A 3 of 3 | | |
| | | | | | VERIFIED MC | CONTOUR INTERVAL MINOR 0.1m MAJOR 1.0m | | | JOB REF: 2014C215 | SCALE: 1:200 | A3 |
| | | | | | | | | | | | |